

Meeting Space ITEEA's 81st Annual Conference Kansas City, MO

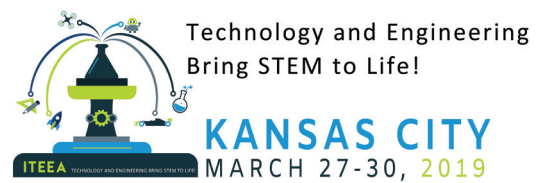

Meeting Space: Ballroom Level

Sheraton
Kansas City
at Crown Center

Ballroom Level

BALLROOM LEVEL

- 1 Boardroom
- 2 The Grand Office
- 3 Atlanta
- 4 New York
- 5 San Francisco
- 6 Chicago
- 7 The Grand Ballroom

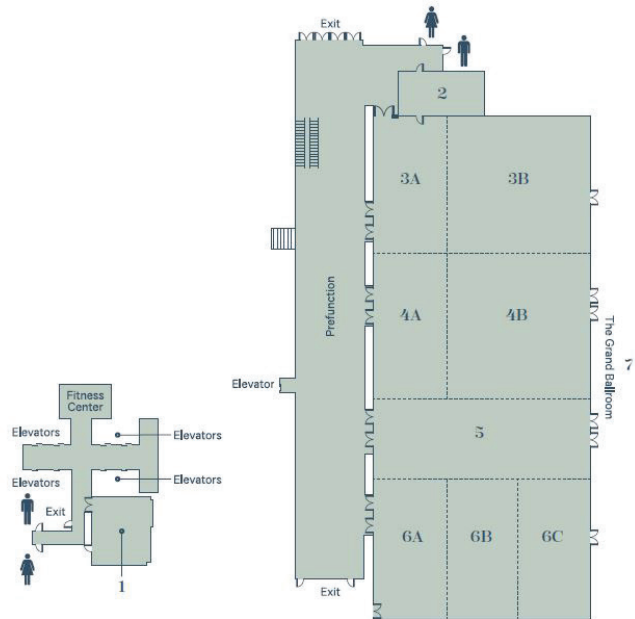

	SQUARE FEET	DIMENSIONS	HEIGHT	THEATER	CONFERENCE	RECEPTION	CLASSROOM	U-SHAPE	SQUARE	ROUND
BOARDROOM	607	22.5' x 27'	9.5'	-	20	-	-	-	-	-
THE GRAND OFFICE	240	20' x 15'	-	-	-	-	-	-	-	-
ATLANTA*	4,754	54.98' x 86.47'	17.98'	546	48	370	288	84	72	280
NEW YORK*	5,010	86.47' x 57.94'	17.98'	651	48	527	336	87	96	280
SAN FRANCISCO*	2,809	86.47' x 32.49'	17.98'	357	72	295	144	75	84	140
CHICAGO*	4,796	86.47' x 55.47'	17.98'	630	72	504	336	84	96	280
THE GRAND BALLROOM*	17,370	86.47' x 200.88'	17.98'	2,332	-	1,828	1,353	-	-	1,320

Sheraton
Kansas City
at Crown Center

Exhibit Hall/ Mezzanine Level

EXHIBIT HALL AND MEZZANINE LEVEL

- 1 Exhibit Hall A
- 2 Exhibit Hall B
- 3 Northrup
- 4 Fremont
- 5 Benton
- 6 Van Horn
- 7 The Terrace
- 8 Chouteau
- 9 Empire

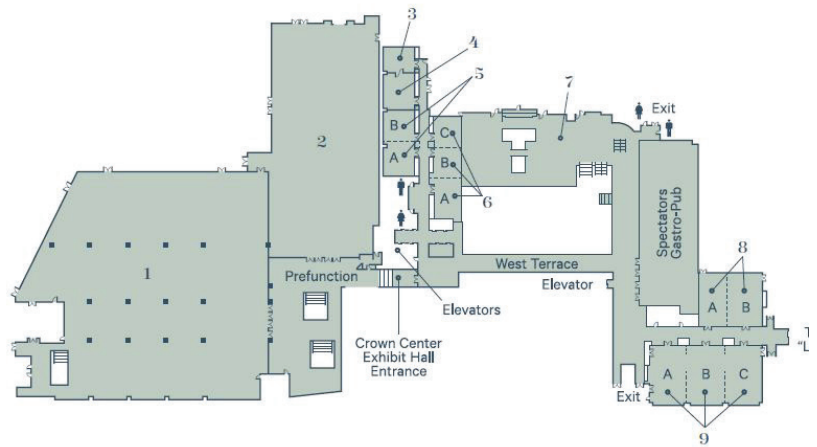

	SQUARE FEET	DIMENSIONS	HEIGHT	THEATER	CONFERENCE	RECEPTION	CLASSROOM	U-SHAPE	SQUARE	ROUND
EXHIBIT HALL A	27,915	200.2' x 178.9'	19.5'	2,550	-	2,938	-	-	-	2,010
EXHIBIT HALL B	15,556	102.4' x 189.3'	19.5'	1,800	-	1,637	1,050	-	-	1,050
NORTHROP	440	27.4' x 19.2'	9.9'	35	12	46	18	15	12	20
FREMONT	674	27.5' x 28'	9.9'	65	18	70	30	18	18	30
BENTON*	1,216	27.5' x 51'	9.9'	99	36	60	48	33	36	80
VAN HORN*	1,669	24.4' x 81.6'	9.9'	180	66	175	90	69	66	60
THE TERRACE	5,606	59.7' x 118.2'	36.6'	360	-	590	-	-	-	220
CHOUTEAU*	2,078	41.2' x 53.1'	9.9'	261	36	218	147	42	54	120
EMPIRE*	3,936	44.9' x 91.4'	9.5'	462	72	414	252	78	90	210

The Westin
Kansas City
at Crown Center

Ballroom Level

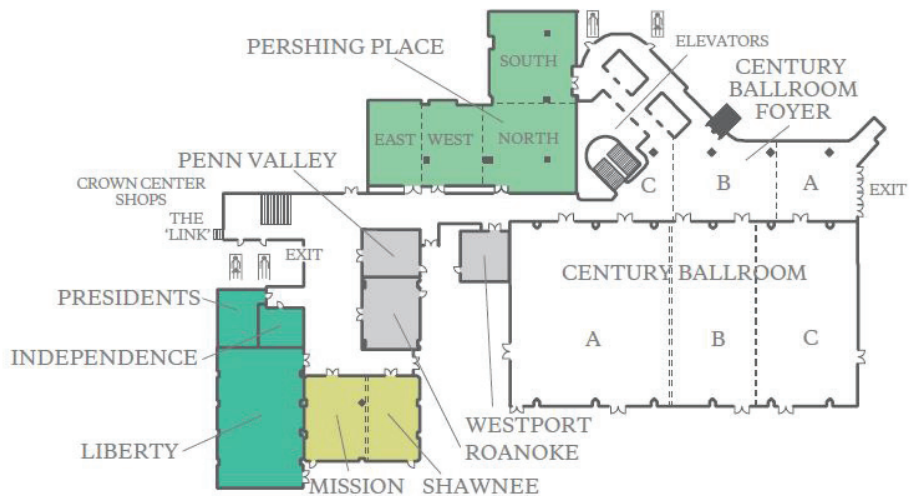

	DIMENSIONS	AREA (SQ. FT.)	MAX CEILING HEIGHT	THEATER	CLASSROOM	BANQUET	CONFERENCE	U-SHAPE	HOLLOW SQ.	RECEPTION
INDEPENDENCE	18' X 21'	378	10.6'	30	18	10	12	9	-	35
LIBERTY	43' X 69'	2,894	10.9'	324	180	260	60	54	60	304
PENN VALLEY	28' X 22'	628	11.9'	60	36	40	18	18	24	66
PERSHING PLACE	89' X 103'	6,097	12'	645	297	430	-	-	-	641
PERSHING EAST	43' X 27'	1,151	12'	90	54	70	30	36	36	121
PERSHING EAST & WEST	44' X 57'	2,355	12'	190	120	150	48	51	54	247
PERSHING EAST, WEST & NORTH	45' X 103'	4,295	12'	464	192	250	48	99	96	452
PERSHING NORTH	44' X 47'	1,966	12'	110	72	140	36	36	30	206
PERSHING NORTH & SOUTH	89' X 47'	3,828	12'	252	156	250	48	81	84	402
PERSHING SOUTH	45' X 44'	1,860	12'	110	75	120	36	33	42	195
PERSHING WEST	43' X 30'	1,225	12'	100	54	60	30	30	30	128
PERSHING WEST & NORTH	45' X 76'	3,172	12'	210	141	220	48	48	54	333
PERSHING WEST, NORTH & SOUTH	89' X 76'	5,046	12'	450	228	300	-	-	-	531
PRESIDENTS	27' X 24'	557	12.1'	54	24	40	18	15	12	58
ROANOKE	29' X 35'	967	11.6'	84	48	60	24	24	36	101
SHAWNEE & MISSION	42' X 57'	2,385	11'	262	156	190	48	48	-	251
MISSION	42' X 31'	1,275	11'	110	63	100	30	39	42	134
SHAWNEE	42' X 26'	1,073	11'	100	63	80	30	36	36	112
WESTPORT	26' X 24'	599	9.3'	50	36	40	12	18	18	63